

[Green Box]	Carpet 1
[Light Green Box]	Carpet 2
[Blue Box]	Sheet vinyl
[Red Box]	Carpet 3
[Dark Red Box]	Carpet 4
[Yellow Box]	Base1 only- cove
[White Box]	Vct 8

Scale: 1:170. (original drawing scale: 1:96)

FINISH PLAN LEGEND		FINISH PLAN KEYED NOTES		GENERAL NOTES	
[White Box]	CARPET - CPT-1 (I.N.O. ON ROOM FINISH SCHEDULE)	[Green Box]	CERAMIC TILE - CT-1	(B1)	ALIGN CARPET TRANSITION WITH EDGE OF GYP CEILING ABOVE
[Cross-hatched Box]	CARPET - CPT-2	[Cloud Shape]	NOT IN PROJECT SCOPE AREA UNLESS OTHERWISE NOTED	(B2)	FLOORING MATERIAL SHALL EXTEND TO TABLE BASE
[Diagonal-hatched Box]	CARPET - CPT-3	[Dotted Box]	LINOLEUM - LIN-2		
[Grid-hatched Box]	CARPET - CPT-4				
[Brick-hatched Box]	STONE TILE - STN-1 (16" x 24" U.O.N.)				



Jacobs Engineering Group Inc.  
 One Financial Plaza  
 507 North Broadway  
 Saint Louis, Missouri 63102-2131  
 Tel: (314) 335-4000  
 Fax: (314) 335-5104

DISCLAIMER  
 ATTACHMENT OF THIS SEAL TO THIS DOCUMENT IS LIMITED TO THE PROJECT AND THE DESIGNATION OF THE PROJECT AS INDICATED HEREIN.  
 REVISIONS:

Number:	Description:	Date:
1	Issued For Permit	01-24-13
1	Issued For Construction	01-30-13
4	ASI #4 - VE REVISIONS	03-04-13

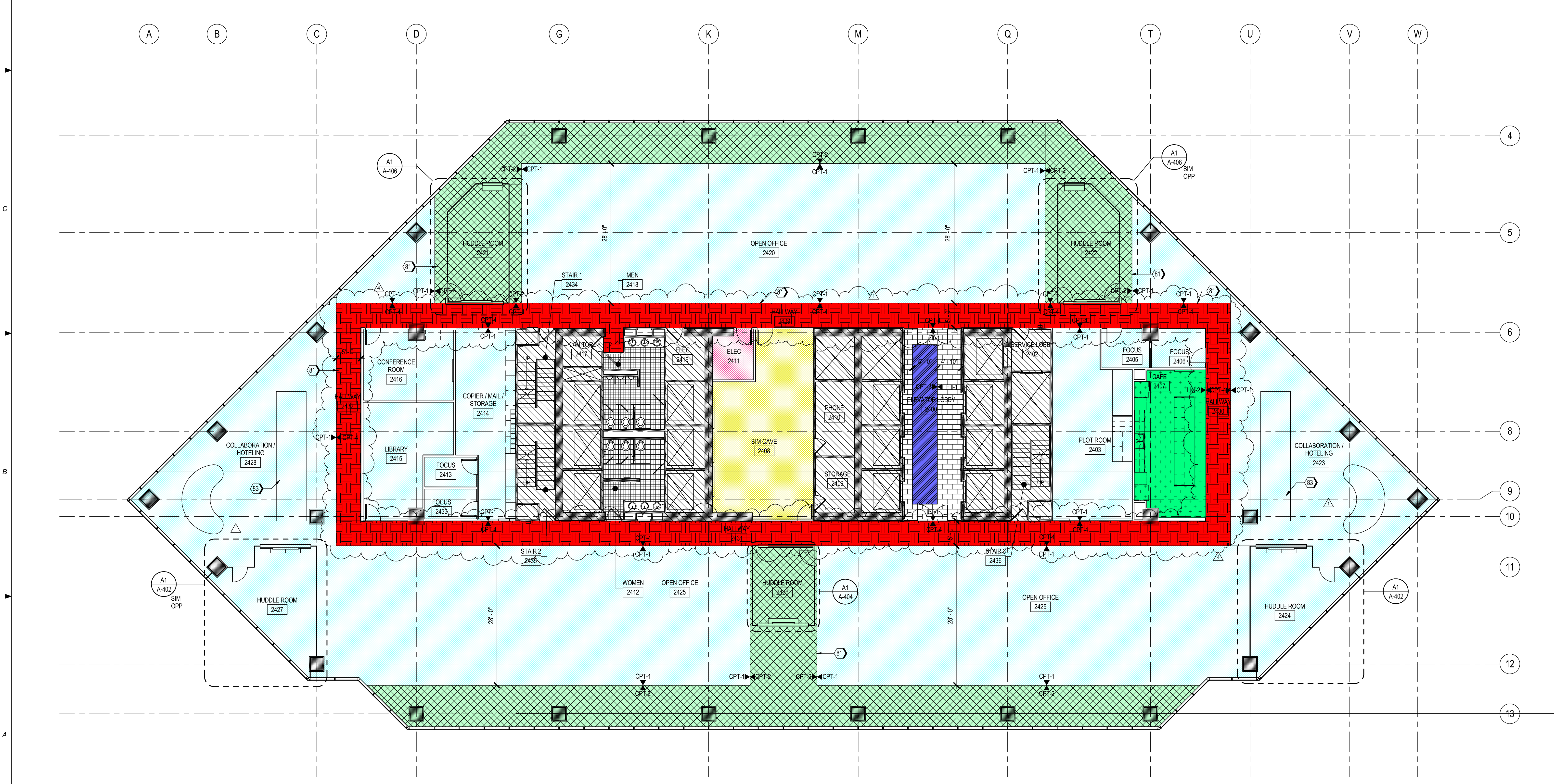

**JACOBS OFFICE RENOVATION**  
 BASEMENT, 24th, 25th, AND 26th FLOOR LEVELS  
 777 MAIN STREET  
 FORT WORTH, TEXAS 76102-5304

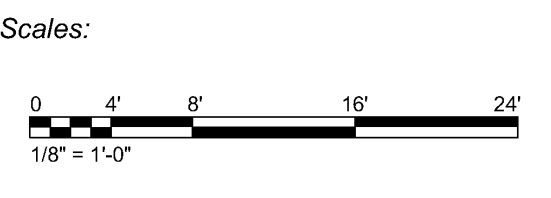

Jacobs Project No.: F3W60291  
 Drawing Title:  
**ARCHITECTURAL**  
**24th LEVEL**  
**FINISH PLAN**

Date: 30 JANUARY 2013  
 Designed By: R. Kading  
 Drawn By: S. Tolsted  
 Checked By: D. Papp  
**A-122**

3/6/2013 2:03:23 PM C:\Users\reddy\Documents\R13-Jacobs-F3W60291-Arch\New-Central\_redy\pdm.rvt  
 A1 24th LEVEL FINISH PLAN  
 1/8" = 1'-0"  
 A413

SCALES INDICATED ARE FOR SIZE 34x44 PLOT